

Apache '73 Owners Manual



To the new Apache owner:

Your new Apache has the most advanced engineering of any folding camping trailer. Many of its features are designed for extra living comfort and convenience. Others make for easy towing and handling, and for fast set-up at the campsite.

This owners manual has been prepared to acquaint you with these features and to explain the proper operation and maintenance of your Apache. It also contains important information regarding the Apache owner's warranty.

Read the entire manual carefully before you set up the trailer for the first time. It's a good idea to keep the manual inside the trailer so it will be available for reference on camping trips.

To be sure your camper gets the expert care it deserves, see your Apache dealer. He has the special tools, genuine parts and technical know-how to keep it in top condition. He also handles the complete line of Apache comfort and convenience accessories.

Apache dealers are located throughout the U. S. and Canada. When traveling, find the dealer nearest you by consulting the Yellow Pages under "Trailers — Camping and Travel".

All instructions and specifications in this manual were considered correct at the time of publication. Vesely Company reserves the right to make changes at any time, without notice, in specifications, designs, equipment and materials.

Index

- Set-up instructions3, 4, 5, 6
- Equipment operation7, 8
- How to keep your Apache looking new9
- To change a wheel10
- Service instructions11
- Specifications and capacities12
- Warranty information13, 14

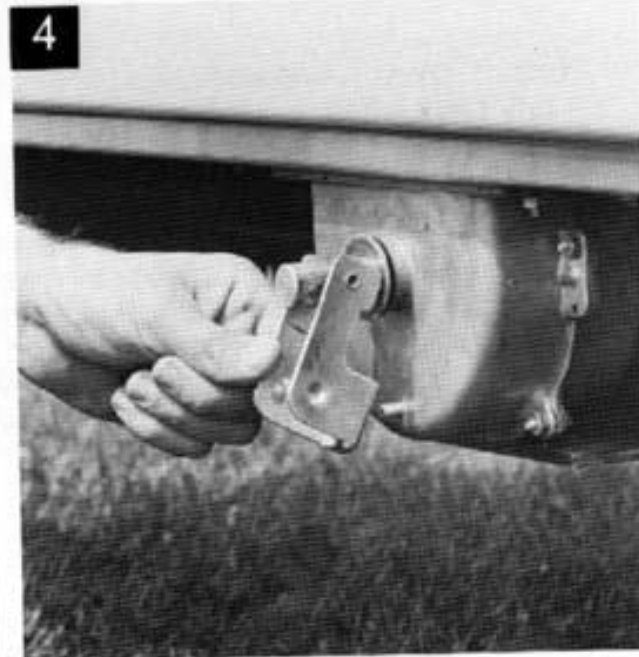
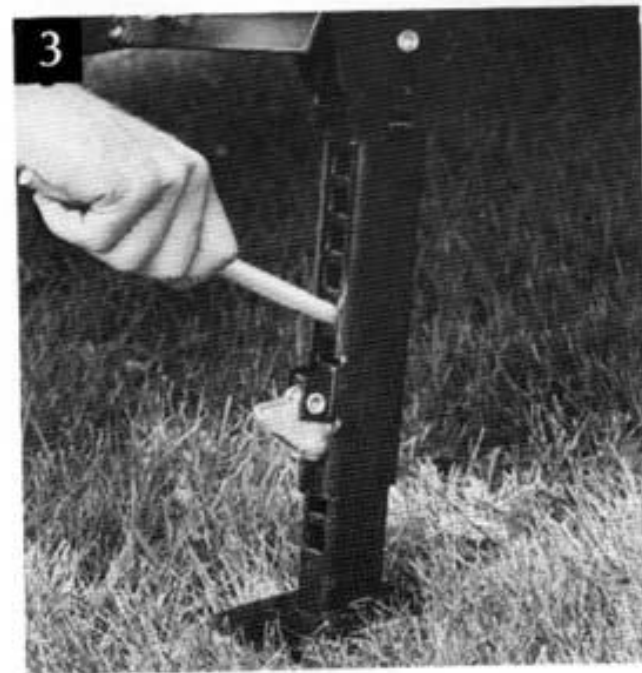
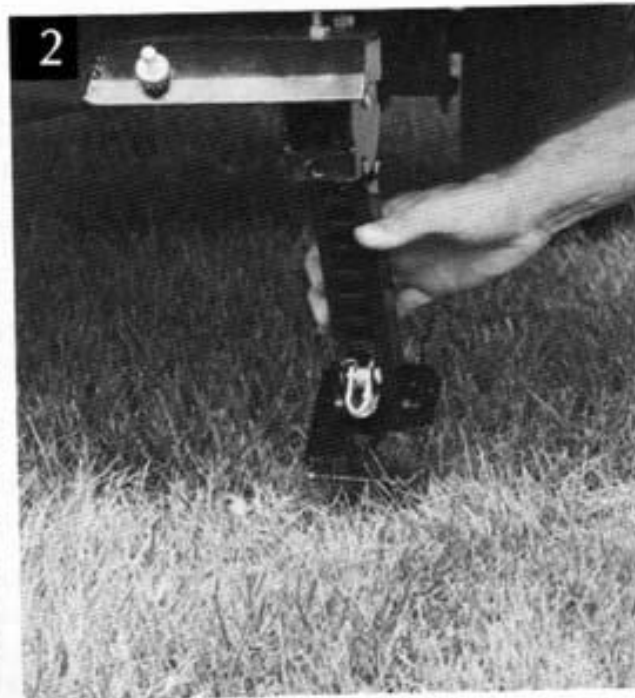
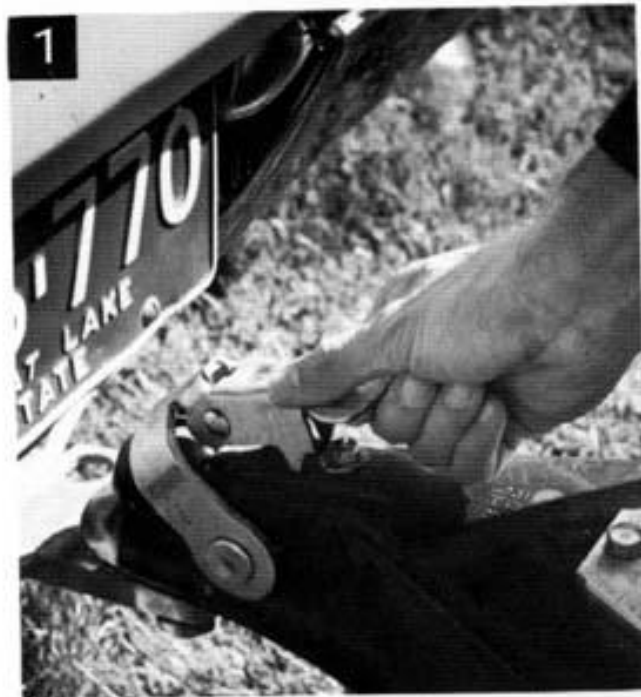

- With trailer attached to car, detach safety chains and electrical hook-up and slip tongue jack wheel over jack sleeves (locking pin on wheel fits into slot in sleeve).
- Unlock coupler from hitch ball by pulling up and back on locking bracket (1).
- Turn tongue jack handle clockwise to raise trailer tongue until coupler is detached from hitch ball.
- Move car ahead and level trailer with tongue jack handle. Release all four leveling legs and swing down to lock position (2).
- Extend each leveling leg to ground by placing foot on base plate and pushing down firmly.
- To complete leveling of trailer, start at lowest corner and insert flat end of leveling leg jack handle all the way through the second slot above the latch (3).
- Depress handle to raise trailer corner upward; follow this procedure at other corners as necessary, until trailer is level front to rear and side to side, and until enough weight has been transferred to the legs for stability.

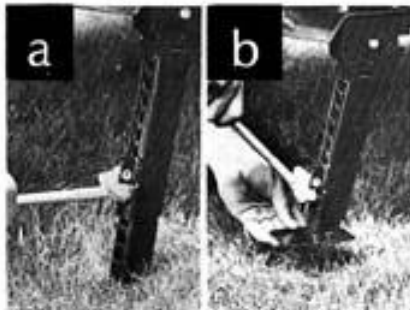

NOTE: To release weight from leveling leg, place flat end of jack handle into slot on underside of latch and lift upward (a). To store leg for travel, slide baseplate upward and return leg to horizontal position (b).

- Release lock on gearbox at rear of trailer (4).
- Insert crank (5) and turn clockwise until change in pressure is detected, indicating road cover is at full height position (6).
- Pull out each bed until it reaches stops (7).
- Install one support leg at each corner of bed by inserting one end of leg over adjustable pin on bracket at end of trailer frame and placing opposite end into recessed bracket beneath the bed (8); raise bed corner slightly to assist. Reach under canvas at side of beds, raise bows and lock in

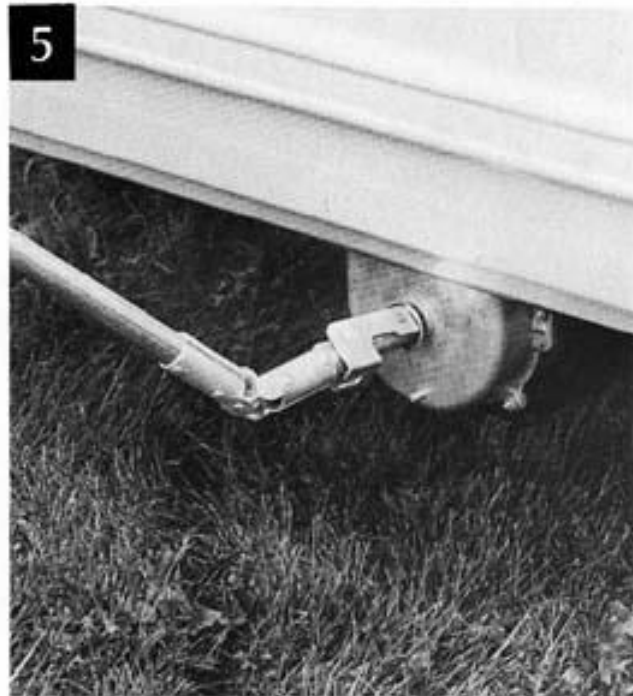

Page 6 placeholder

(13). • Raise door frame approximately $\frac{1}{4}$ " and slide extrusion ends over the flat stud projections at either side of door opening (14). • Lock upper and lower door sections together with turn button on inside. Attach canvas to door frame by inserting long end of vinyl canvas lock into channel of door frame (15). • The lock is secured by pushing it toward the door and seating the short end of the lock into the door frame channel (16).

• Tension on the canvas will keep lock in position. To remove when striking, push vinyl lock strip away from door, disengage and remove.

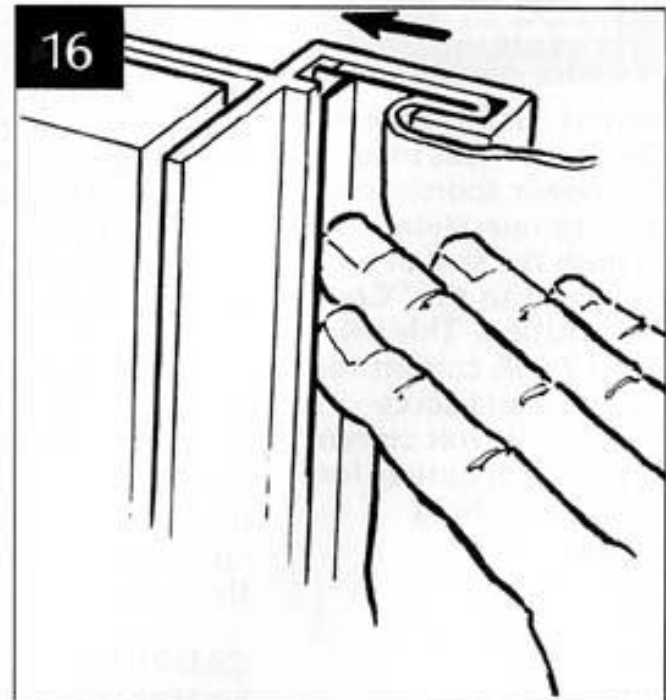
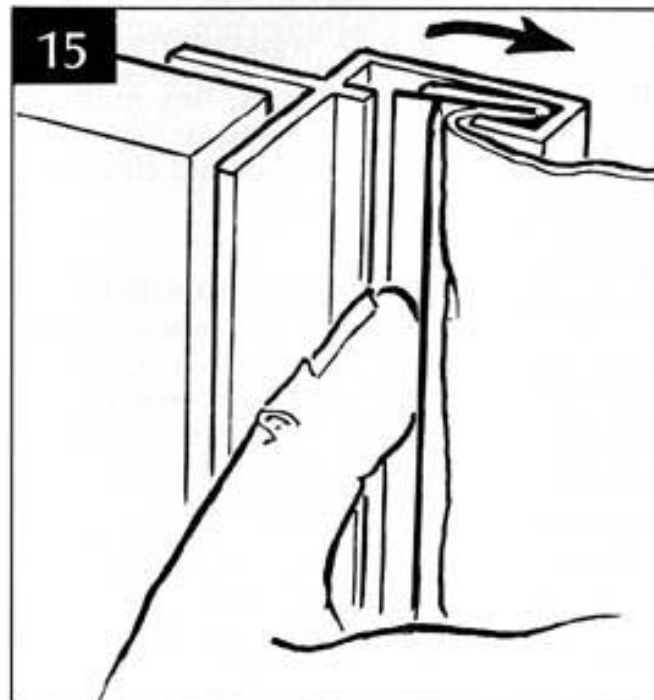

(Right door frame illustrated)